

PLAN VIEWS (INSETS)

EARLY WARNING SYSTEM

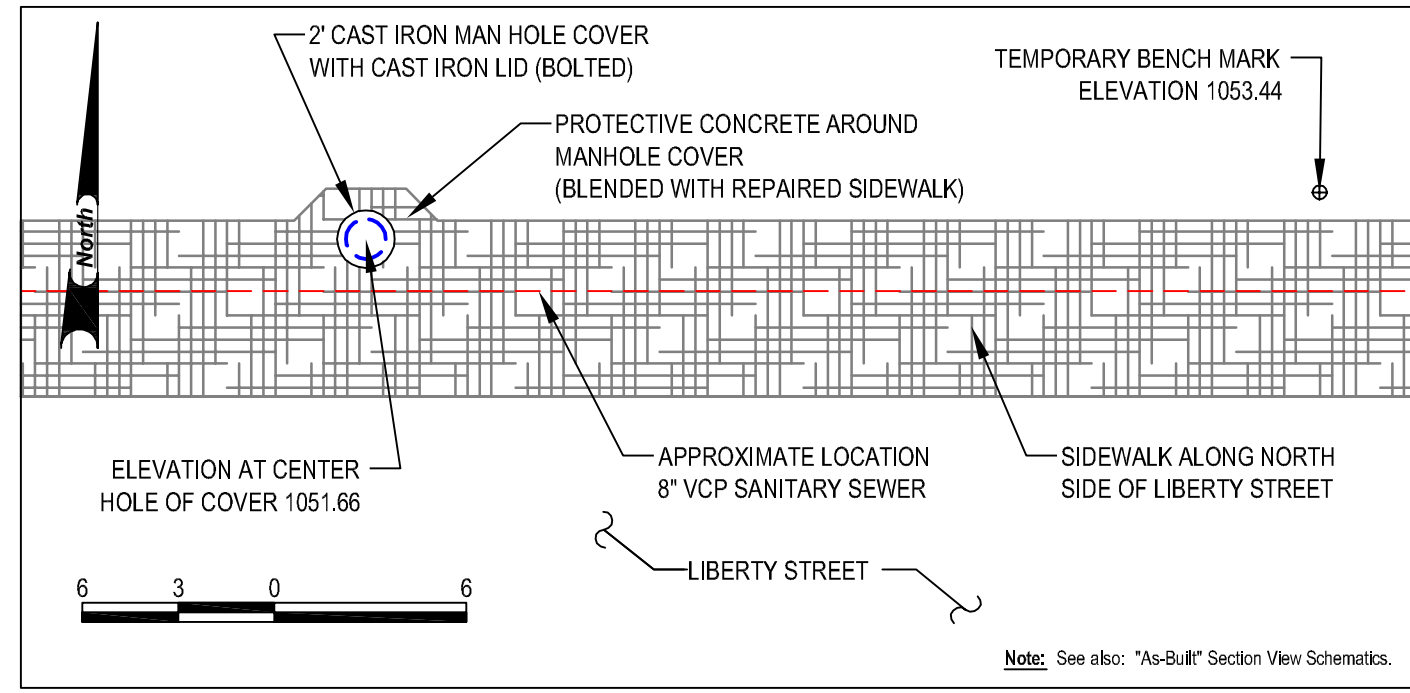

SECONDARY DRAIN

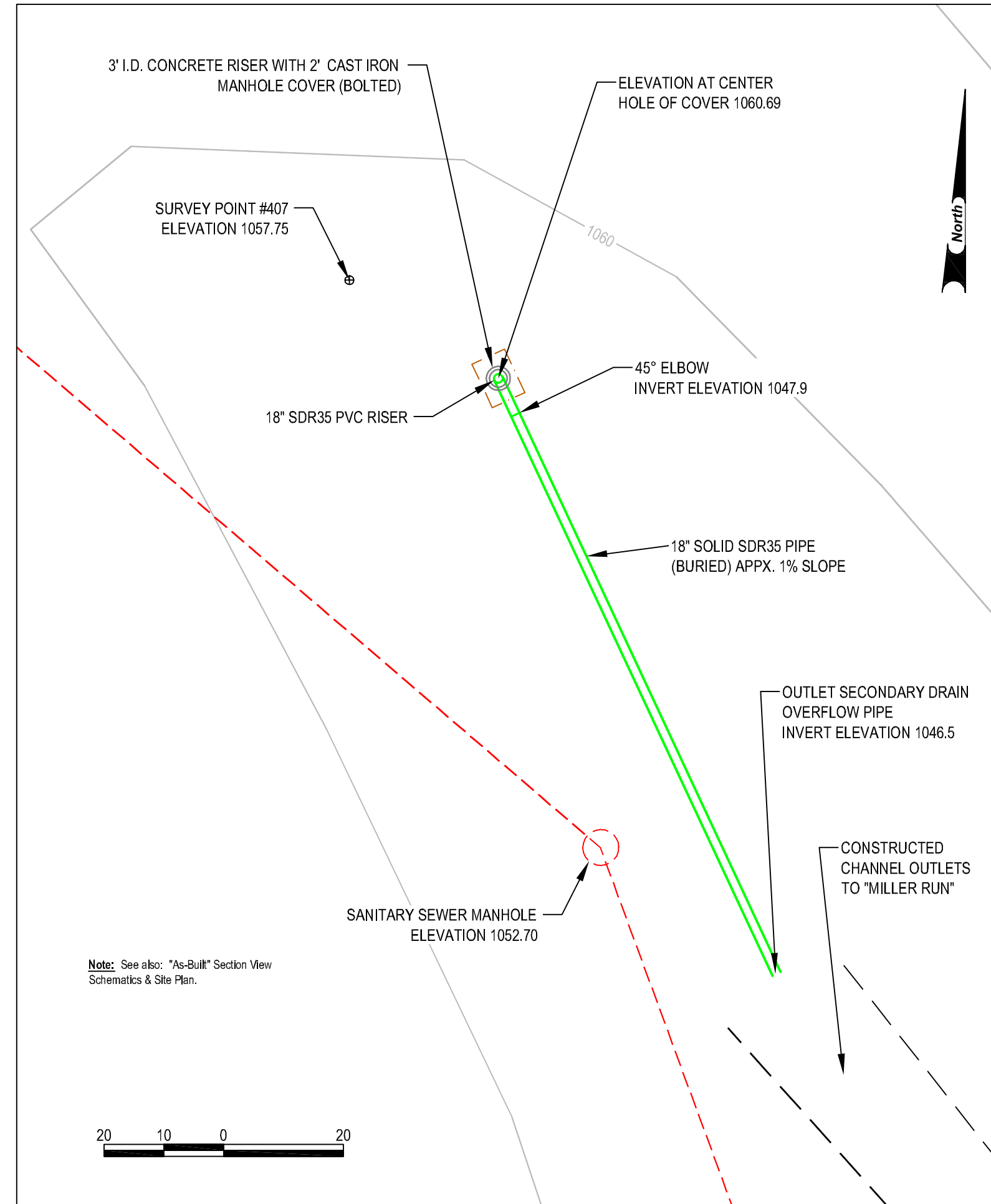

PRIMARY DRAIN

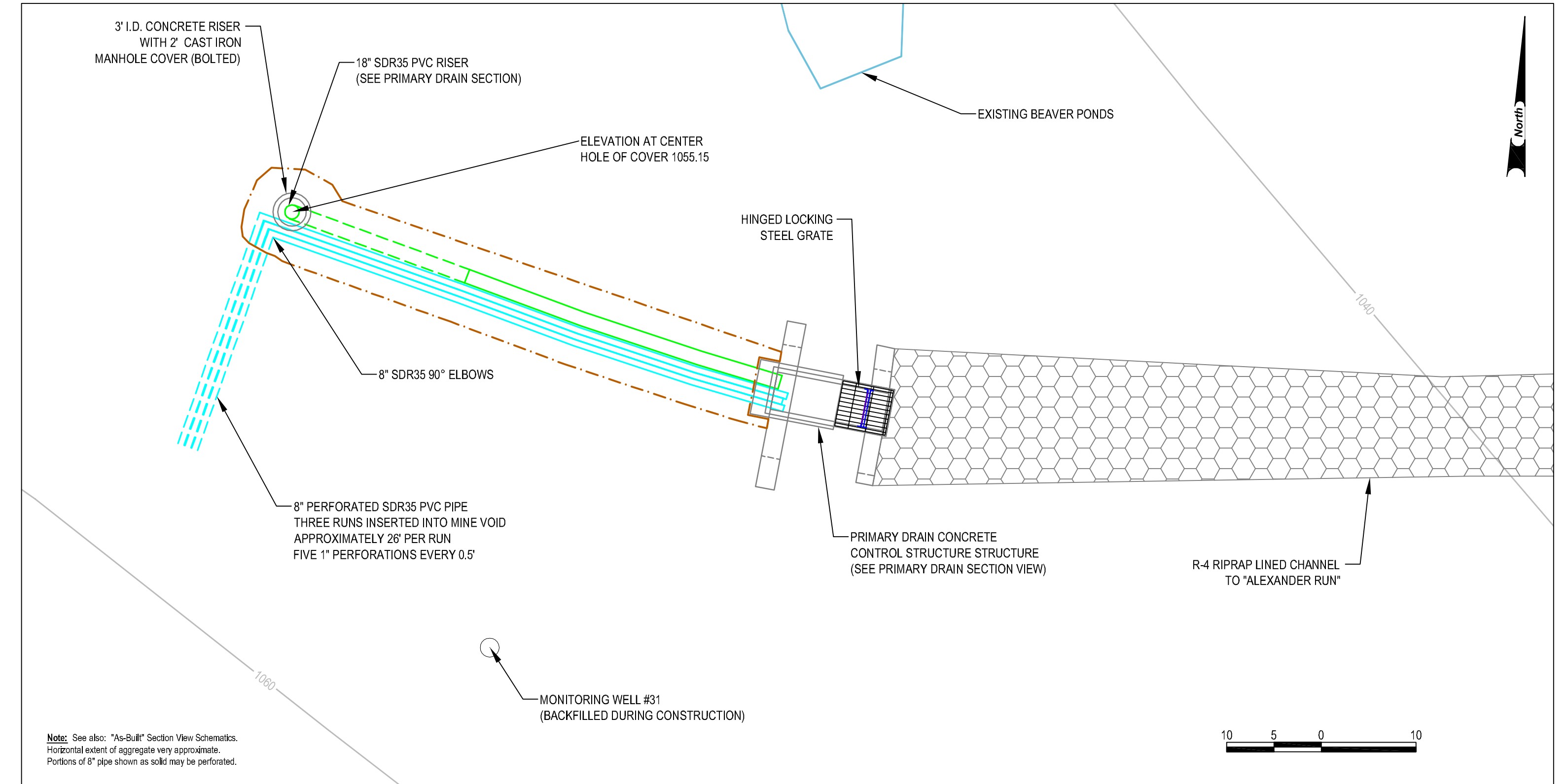

Notes:
Surface contours digitized from USGS 7.5' Canonsburg, PA (PR:1979) and Oakdale, PA (PR:1980) and rectified with elevation information from available data from Operation Scardiff (circa 1980) and recent EDM surveys completed by PA DEP, BAMR. Current surface elevations based on USGS monument (Elev. 979) located near the intersection of South McDonald St. and Robinson Run, other surface elevations from previous investigations and historic data assumed to be on the same vertical datum. Though there seems to be a good correlation among the various data sets, consistent vertical control has not been confirmed.

Sanitary sewer shown to the east of Roark Street digitized from McDonald Sewer Authority, Fannie Street Sewer Extension, plans provided by Chester Engineers, dated 3/90 (rev. 4/91). Location and alignment based on PA DEP, BAMR EDM survey of select manholes near construction area. Sanitary sewer along north side Liberty Street encountered during Early Warning System installation and located by visual approximation.

Roads and streams digitized from aerial photography provided by Southwestern Pennsylvania Commission (photo taken on 4/26/00).

Drill hole 31 located by PA DEP, BAMR EDM survey.

Only select utilities shown. Numerous overhead and underground utilities present and not shown on plan.

"As-Built" survey information provided by PA DEP, BAMR from June 2005 EDM "as-built" survey. Access Road - Primary Drain - concrete control structure, manhole cover and riprap channel; Secondary Drain - manhole cover, overflow pipe outlet, channel and culvert, Early Warning System - manhole cover and top of 15' riser.

"As-Built" elevation data for Primary Drain, Secondary Drain and Early Warning System from laser level measurements taken by EIS personnel during construction using PA DEP, BAMR EDM reference survey points.

All dimensions in feet unless otherwise noted.

Actual horizontal extent of excavations and aggregate very approximate.

SECTION VIEW (SCHEMATICS)

EARLY WARNING SYSTEM

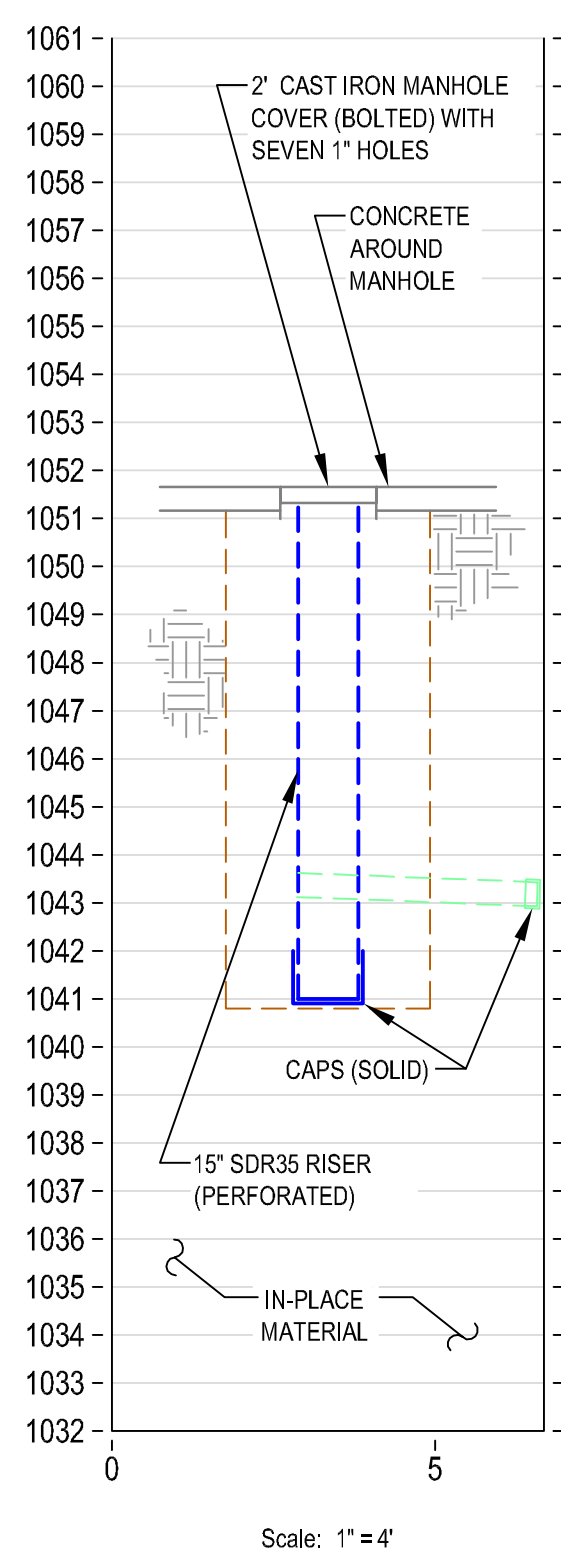

SECONDARY DRAIN

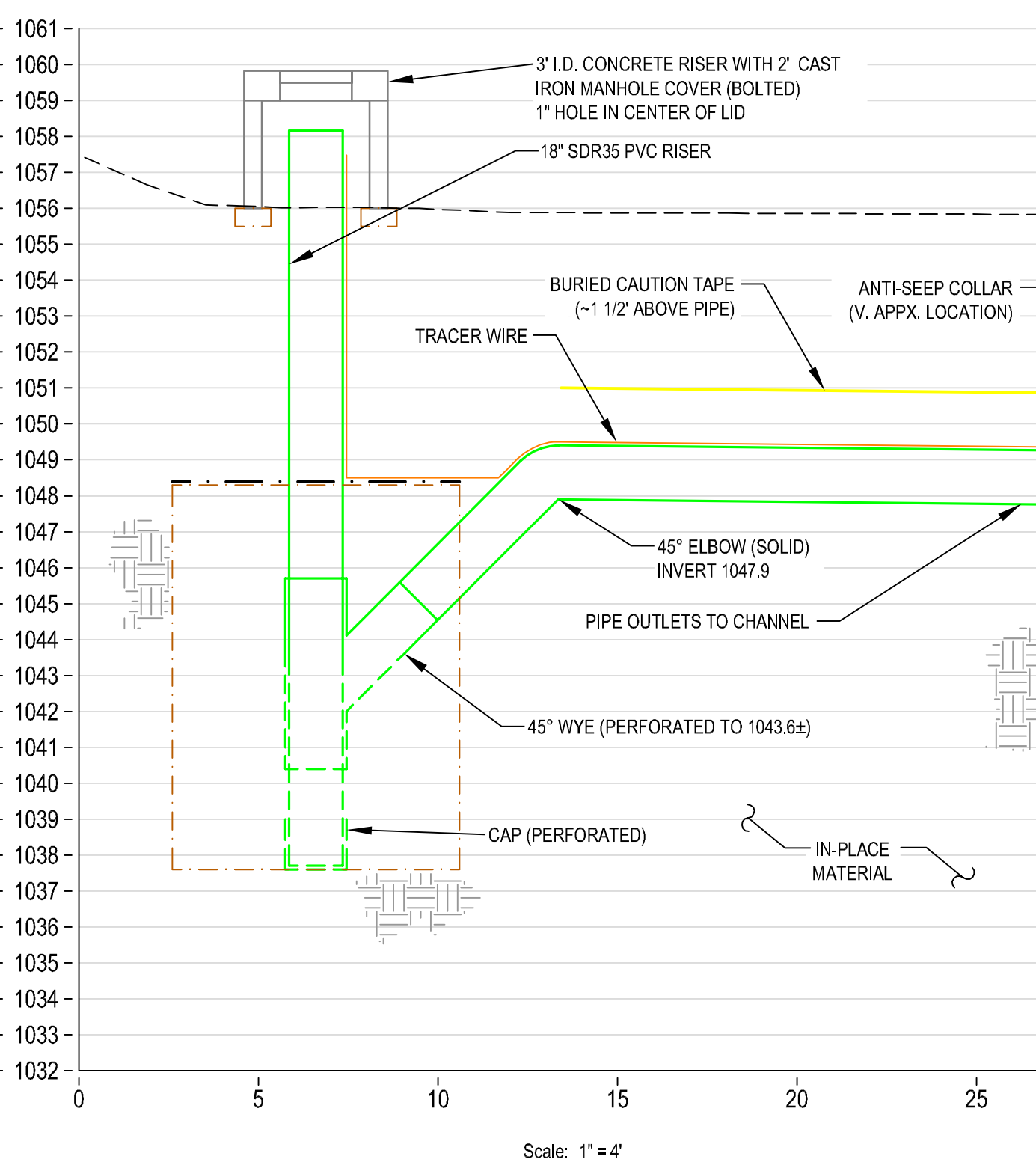

PRIMARY DRAIN

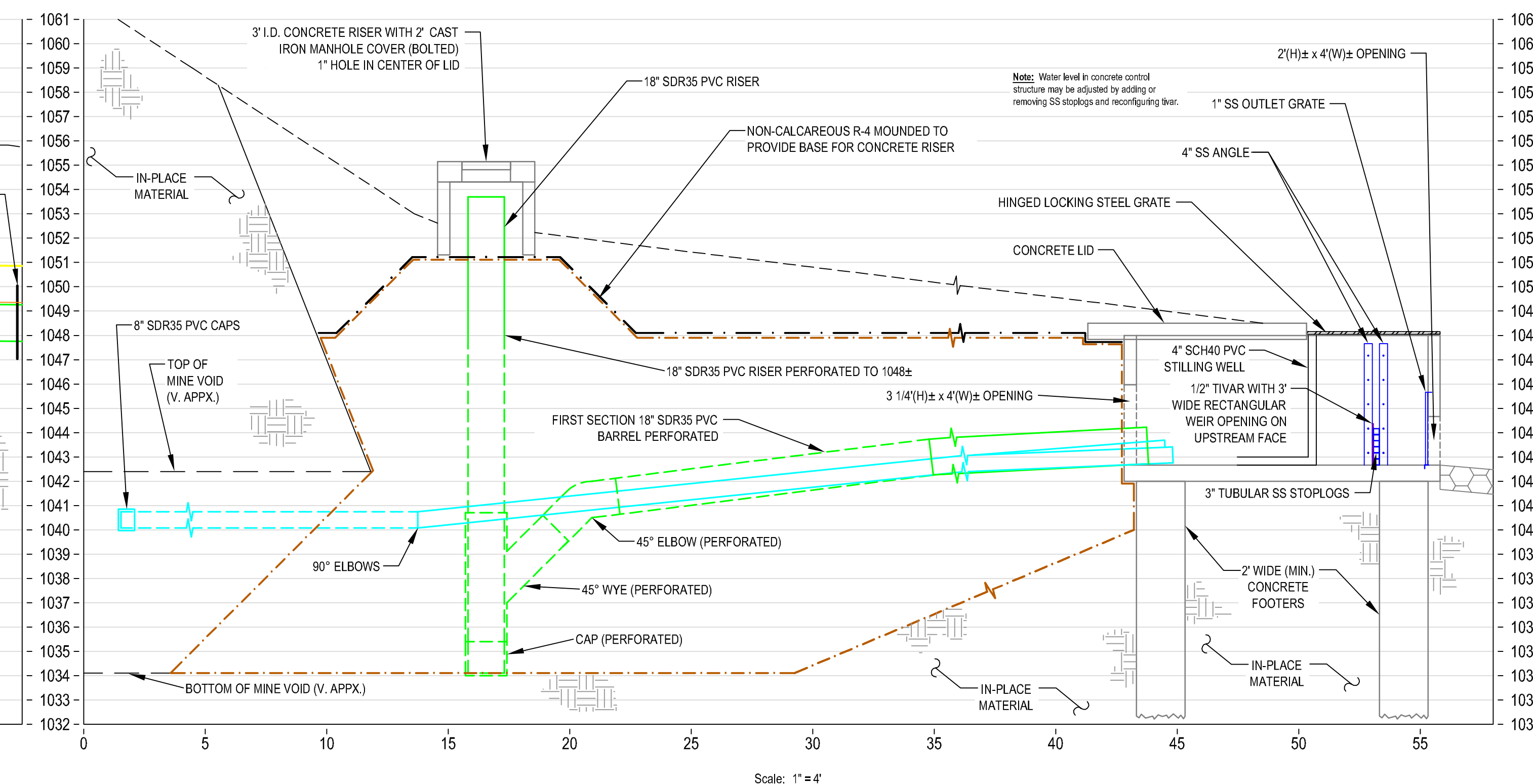

LEGEND

- USGS CONTOUR
- CONCRETE STRUCTURE
- - - APPX. LOCATION BOTTOM OF FOOTER
- WATER
- 18" SDR35 PVC PIPE (SOLID)
- 18" SDR35 PVC PIPE (PERFORATED)
- 15" SDR35 PVC PIPE (SOLID)
- 15" SDR35 PVC PIPE (PERFORATED)
- 8" SDR35 PVC PIPE (SOLID)
- 8" SDR35 PVC PIPE (PERFORATED)
- 6" SDR35 PVC PIPE (PERFORATED)
- R-4 NON-CALCAREOUS RIPRAP
- PADOT #3 NON-CALCAREOUS AGGREGATE
- FINAL GRADE (V. APPX.)
- GEOTEXTILE
- CAUTION TAPE
- TRACER WIRE
- R-4 LINED CHANNEL
- SANITARY SEWER LINE
- STAINLESS STEEL (SS) HARDWARE

PLANS AND SECTIONS

"AS-BUILTS"

NICKLE PLATE MINE
PA DEP, BAMR
MCDONALD SOUTH - OSM 63(1441)101.1

McDonald Borough & North Fayette and Robinson Townships
Allegheny and Washington Counties, Pennsylvania
Scale: Varies June 30, 2005
Environmentally Innovative Solutions, LLC
Pittsburgh, PA